

MATERIAL LIST			
ITEM	KEMCO PART #	DESCRIPTION	QTY FOR QTY
1	BFJ	FLAT BAR, AL, 1/4" X 1/2", CUT TO 16"	1
2	BFJ	FLAT BAR, AL, 1/4" X 1/2", CUT TO 12"	2

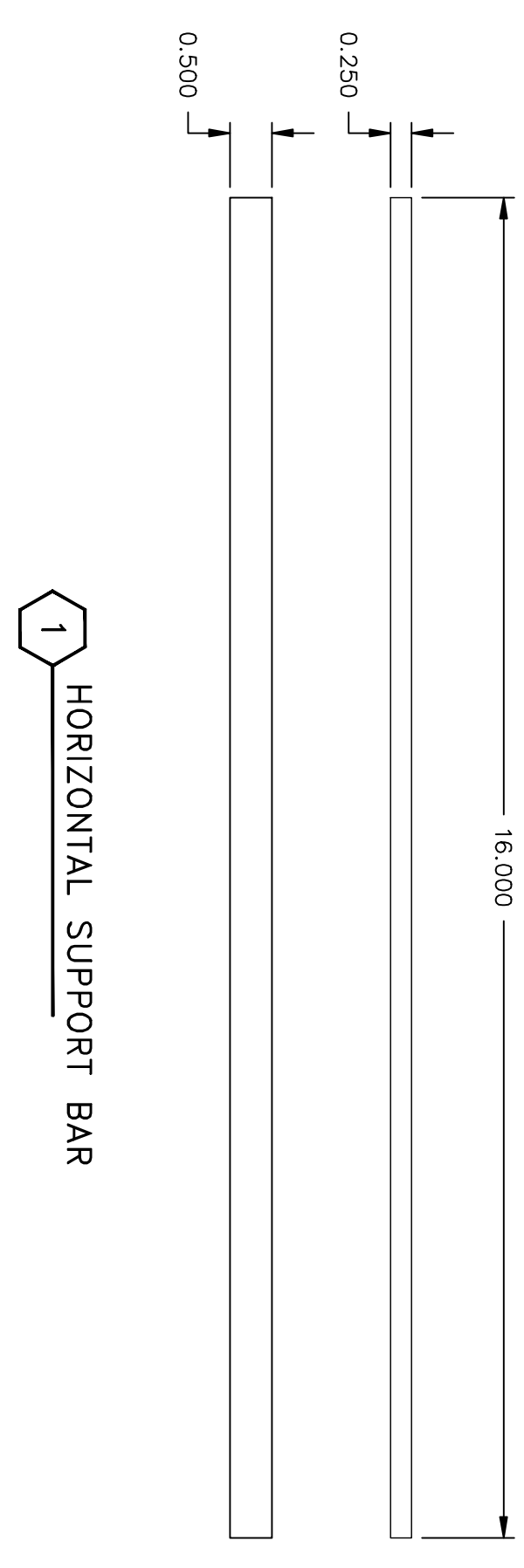

1 HORIZONTAL SUPPORT BAR

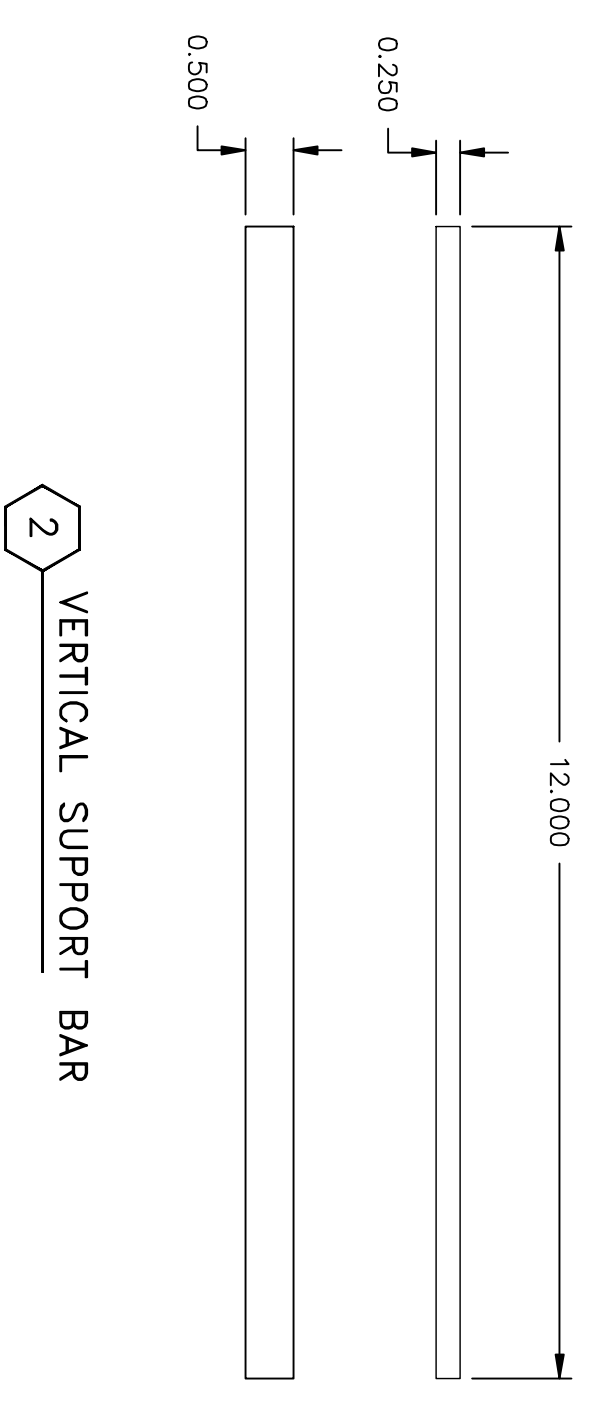

2 VERTICAL SUPPORT BAR

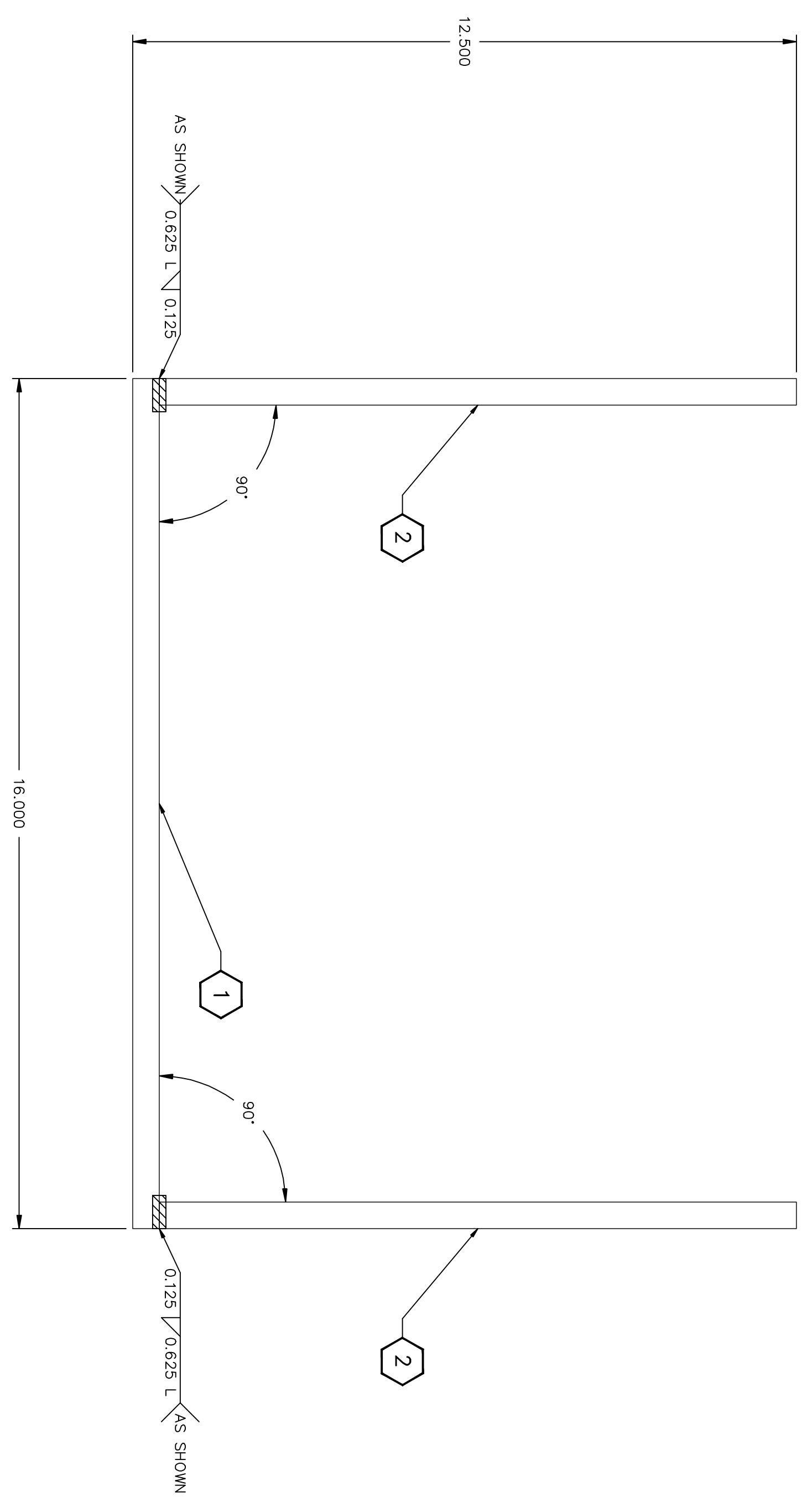
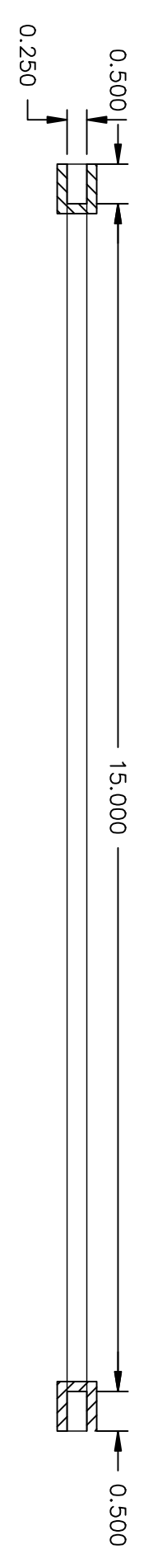

- UNLESS OTHERWISE NOTED:
- 1) ALL DIMENSIONS ARE IN INCHES. EDGES SHALL BE CHAMFERED UNLESS OTHERWISE SPECIFIED.
  - 2) FILL DIMENSIONS ARE IN INCHES. EDGES SHALL BE CHAMFERED UNLESS OTHERWISE SPECIFIED.
  - 3) PRIME ALL PARTS WITH PROHIBITIVE EPOXY.
  - 4) INTERIOR FINISH TO BE - UNFINISHED. EXTERIOR FINISH TO BE - UNFINISHED.

Tolerance unless otherwise specified		KEMCO Industries, LLC.	
FRACT 1/32	Scale: 1/2" = 1"	70 Keyes Court, Sanford, FL 32773	Drawn by: ARB
.x	Plot Scale: 1:2		Date: 09-20-12
.xx ±.03		CHASSIS - POY DISPLAY - WELD ASSEMBLY	
.xxx ±.030		UNIVERSITY OF CENTRAL FLORIDA	
ANGLES ±1.0°		SENIOR DESIGN GROUP 8 - FALL 2012	
SURFACES N/A		KEMCO INDUSTRIES, LLC	Drawing No.: 12R007-EM4